

Installation Instructions

Savercell and Savercell Plus

Questions? 800-765-3237 or visit www.mediproducts.net

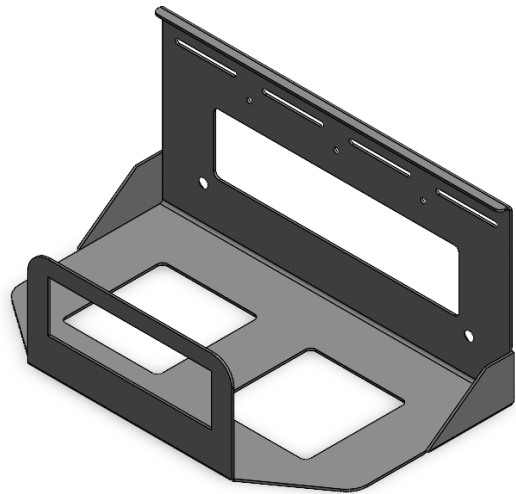

BEFORE YOU BEGIN:

Read these instructions carefully before attempting to install this product.

- **Note to Installer** – Be sure to leave these instructions with the end user.
- **Skill Level** - Installation of this appliance requires basic mechanical skills.
- Proper Installation is the responsibility of the installer.
- Product failure due to improper installation is not covered under the warranty.
- This product should not be altered in anyway without manufacturers consent.

• **IMPORTANT** — Save these Instructions for local inspectors use.

• **IMPORTANT** — Observe all governing codes and ordinances.

FOR YOUR SAFETY:

- Be sure all hardwire electrical connections are done by a certified electrical contractor.
- Always wear protective eye, hand and footwear while assembling this system.

Prepare for the Installation

Needed Tools:



Gloves



Wrench

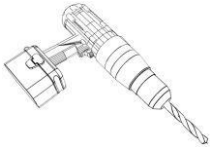

Screw
Gun/Drill

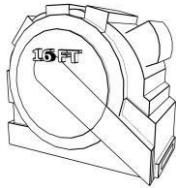

Tape
Measure

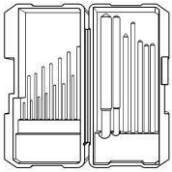

Drill Bit
Set

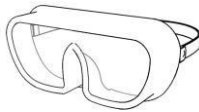

Safety
Glasses



Stud
Finder



Pencil

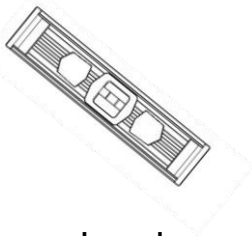

Level



Phillips Head
& 1/4" Hex Bit

Parts & Supplies Provided:

Savercell Wall Bracket

Flip Toggle Fasteners & Bolts

User Manual & Testing Guide

PRE-INSTALLATION STEPS

Prepare your Wall:

Identify the area on the wall where you will be mounting the Savercell system.

Check all measurements to ensure there will be no obstructions. You will need a space that is at minimum 18" wide and 9" high, with at least 6" above and 4" on either side free. Also ensure the mounting location is close enough to an outlet to plug in the Savercell system, and close enough to your appliances to be plugged in as well.

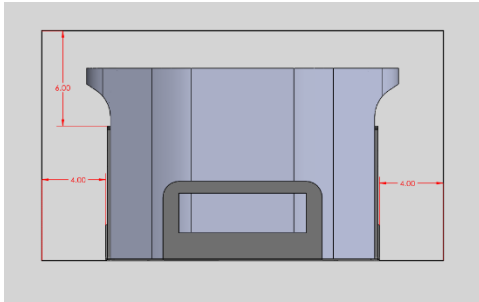

If installing the Savercell Plus Extra Battery, mount your second bracket at least 8" below your first bracket.

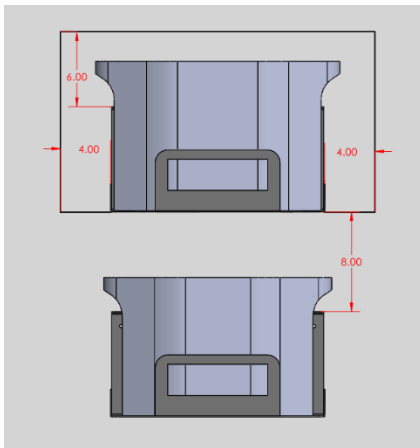

The space directly above and on the sides will need to be accessible to remove the system from the wall bracket, and for future servicing.

Locate and mark the wall studs directly behind the intended location where the bracket will be mounted using a stud finder.

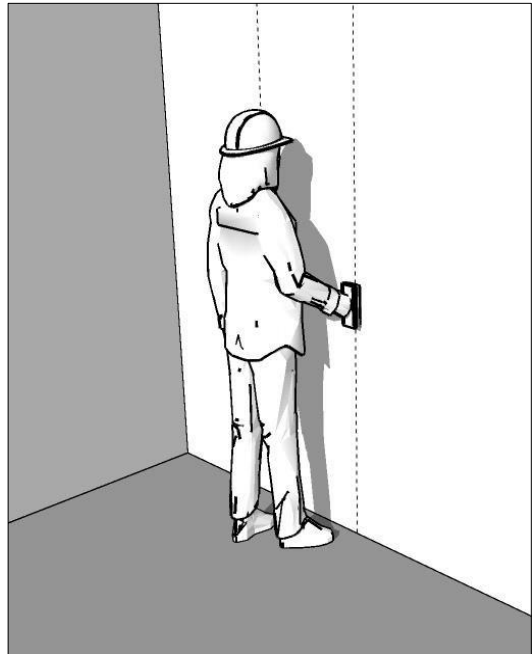

It's important that your bracket is fastened to at least 1 sturdy wall stud, preferably 2 if possible.

Un-Wrap Bracket & Prepare for Mounting:

Unwrap bracket and dispose of wrapping material, setting aside the wall anchor bolts and toggle anchors.

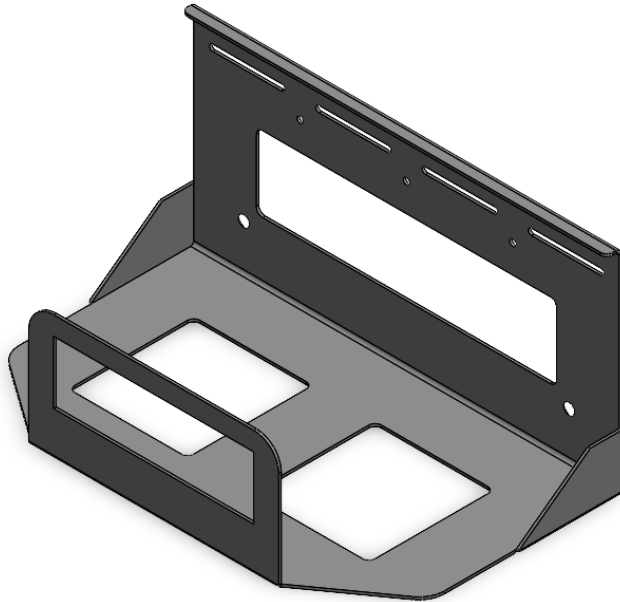

The Savercell Wall Bracket comes with four wall anchors to secure the bracket to the wall. You may use either the $\frac{1}{4}$ " slots or the $\frac{1}{4}$ " holes located near the top of the bracket to secure the bracket to the wall (Highlighted in red below).

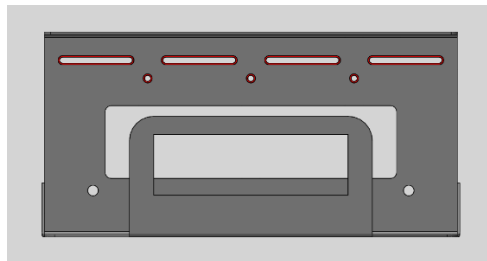

Hold the bracket up to the wall and mark each mounting hole. If possible be sure that at least one of the mounting points lines up with a wall stud, like in the image below.

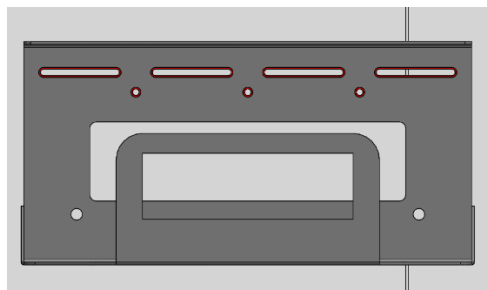

INSTALLATION STEPS

Mounting Bracket to Wall:

For installations that involve securing to metal studs, drill out the marked holes using a ½” drill bit, ensuring the hole is in the middle of the studs, if possible.

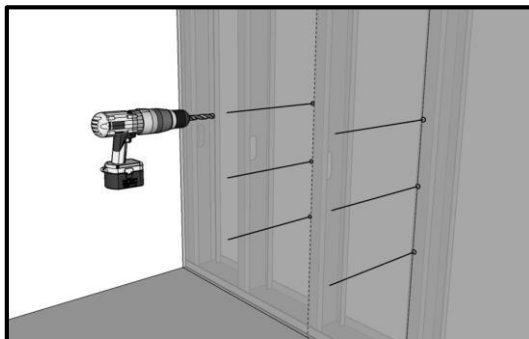

For installations that involve wood studs, pre-drill the marked holes with the appropriate bit for 3/8” lag bolts.

Install the provided toggle wall fasteners into the ½” holes ensuring the toggle plate is horizontal. Once the toggle is in the wall, pull slightly so the toggle is flat against the inside of the wall, and push the cap so it is tight to the outside of the wall. Snap off the excess sticking out of the hole.

Below is an image showing how to install the toggle wall fastener:

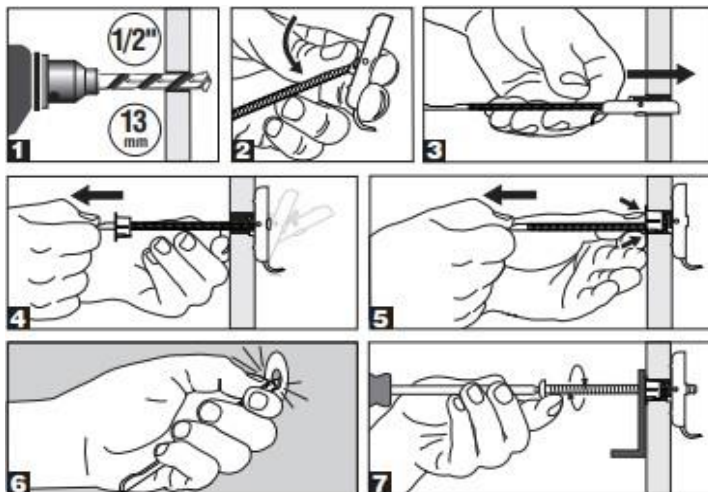

Mounting Bracket to Wall (continued):

Once the wall fasteners are all in place, Hold the wall bracket against the wall and secure the bracket to the wall by screwing the ¼-20 anchor bolts into the holes, and tightening.

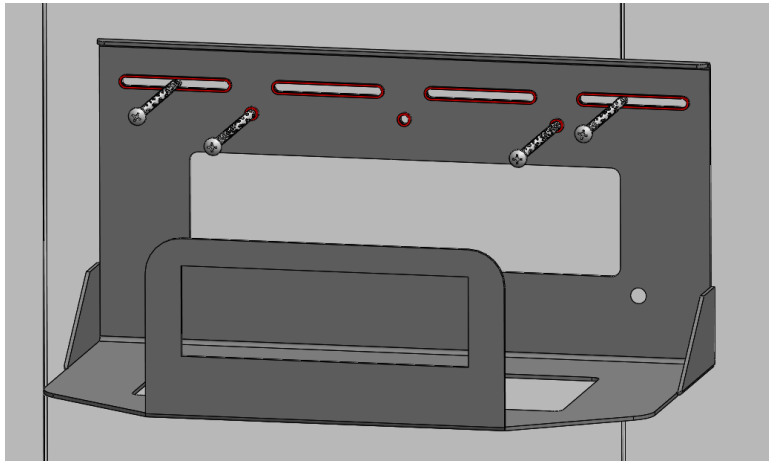

You can now place your Savercell system in the wall bracket.

Continue with the appropriate start up procedure, once again ensuring the Savercell can be plugged in to the wall outlet.

If installing a Savercell Plus, repeat these steps with the additional wall bracket for the extra battery cell. Once the second wall bracket is installed, you may place the extra battery into the bracket, and continue with the appropriate start up procedure, making sure the extra battery is connected to the Savercell system.